



Doncaster Close  
Stevenage | SG1 5RY

AGENT HYBRID



Guide Price £300,000 -  
£310,000



We welcome to the market, a CHAIN FREE, well presented, Two Bedroom Mid Terraced Home, located on the periphery of the highly sought after Chells Manor area of Stevenage. Accommodation briefly comprises of. An Entrance Lobby, with door leading into a good-sized, bay fronted Lounge. From here, an internal door leads into a Modern Kitchen/Diner. Stairs rise to the first floor landing, where doors lead to Two Double Bedrooms and the Bathroom. Externally, the property benefits from a well-maintained South East facing Rear Garden, featuring from a good sized workshop/shed with power & lighting. Also to the rear you will find an Allocated Parking Space. An Ideal First Time or Investment Purchase, viewing comes highly recommended.

DIMENSIONS

- Entrance Hall
- Lounge 14'9 x 9'8
- Kitchen/Diner 12'10 x 7'8
- Bedroom 1: 12'10 x 9'8
- Bedroom 2: 12'11 x 7'0
- Bathroom 7'9 x 5'0

Energy Efficiency Rating		
	Current	Potential
Very energy efficient - lower running costs		
(92 plus) A		90
(81-91) B		
(69-80) C		
(55-68) D		
	66	

Ground Floor  
Approx. 281.3 sq. feet

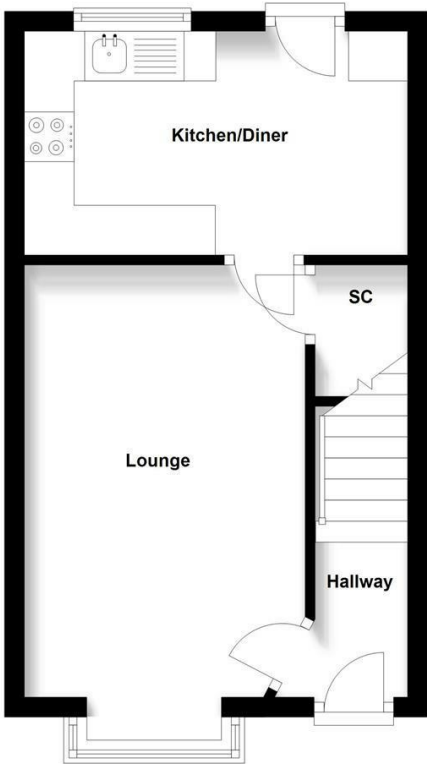

First Floor  
Approx. 278.2 sq. feet

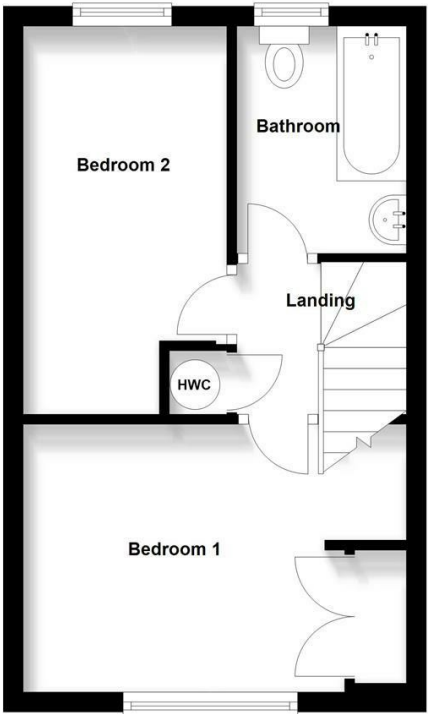

Total area: approx. 559.5 sq. feet

IMPORTANT: We would like to inform prospective purchasers that these sales particulars have been prepared as a general guide only. A details survey has not been carried out, not the service, appliances and fittings tested. Rome sizes should not be relied upon for furnishing purposed and are approximate. If floor plans are included, they are for guidance and illustration purposes only and may not be to scale. If there are any important matters likely to affect your decision to buy, please contact us before viewing the property.

Agent Hybrid  
57 High Street, Stevenage, Hertfordshire, SG1 3AQ  
Tel: 01438 870673 - enquiries@agenthybrid.co.uk  
www.agenthybrid.co.uk

AGENT HYBRID